

# ACELITE HOME

## LEVEL 2 ELECTRIC VEHICLE CHARGER

### SPECIFICATIONS

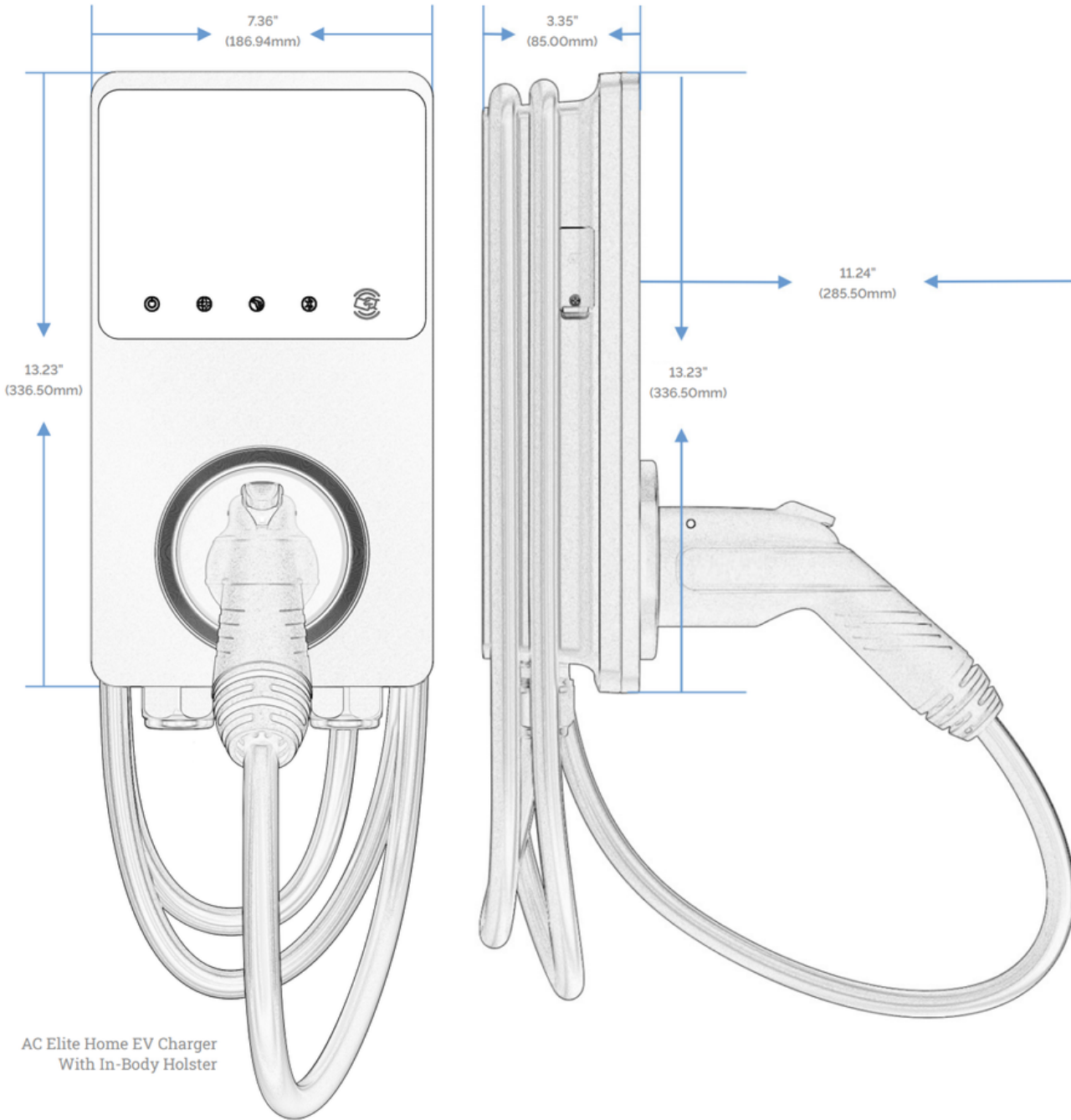

AC Elite Home EV Charger  
With In-Body Holster



UL & CSA Certified



Energy Efficient



Satisfaction Guarantee

## POWER

### INPUT/OUTPUT POWER RATING & CURRENT

9.6kW (240V AC\*40A) Or 12kW (240V AC\*50A)

Output Amperage Adjustable Via Mobile App, From 6A To 40A Or 50A  
208V±15%; 240V±15%, 60Hz

### INPUT/OUTPUT VOLTAGE

L1/N+PE, L1/L2/PE

### NETWORK TYPE

SAE J1772, 25' (7.5m)

### CONNECTOR TYPE

20mA CCID

### GROUND FAULT DETECTION PROTECTION

Overcurrent, Overvoltage, Undervoltage, Integrated Surge Protection  
+/- 1.0% From 1% To Full Scale

### POWER MEASUREMENT ACCURACY POWER CORD

NEMA 6-50 / NEMA 14-50 / Hardwired

## OPERATIONAL RATINGS

### ENCLOSURE RATING

NEMA 4

### OPERATING TEMPERATURE RANGE

-40°F ~+131°F (-40°C ~+55°C)

### STORAGE TEMPERATURE RANGE

-40°F ~+185°F (-40°C ~+85 °C)

### MOUNTING

Wall Or Floor Using A Pedestal

### DIMENSIONS (H\*W\*D)

13"x7"x3" (336x187x85mm)

### WEIGHT TOTAL (INCLUDES CHARGER, GABLE, GUN & HOLSTER)

Ranges Between 13lbs. (5.9 kg) - 15.9 lbs. (7.2 kg) Based On Model

## USER INTERFACE

### STATUS INDICATION

LED/APP

### USER INTERFACE

EV-olution Charge APP; EV-olution Charge Cloud

### CONNECTIVITY

Bluetooth, Wi-Fi, Ethernet, CAN, RS485 (For Energy Meter Connection)

### COMMUNICATION PROTOCOLS

OCPP 1.6J (Can Be Upgraded To OCPP 2.0.1 Later)

### USER AUTHENTICATION

APP, AutoStart, RFID Card

### CARD READER

Optional: ISO 15693, ISO 14443, NFC

### SOFTWARE UPDATE

OTA

## CERTIFICATION & STANDARDS

### SAFETY & COMPLIANCE

UL 2231-1, UL 2231-2, UL2594, NEC Article 625, CSA C22.2, UL

### EMC COMPLIANCE

916 FCC 15 Class B

### CERTIFICATION

Energy Star, OpenADR 2.0b

### WARRANTY

36 Months